

The Australian designed and manufactured, **Autoflo Wall Mount ON/OFF** Mains Power KIT is specifically designed so hospitals and health care facilities to upgrade their existing infrastructure with technology suited to these critical environments.

The **Autoflo Wall Mount ON/OFF** is a built for purpose product, with clever features incorporated. The “wowo” sensor has the critical feature of automatic self-flushing, which is critical in the prevention of potential legionella contamination, which is a must for health care environments. The default setting is a 72hr auto-flush from the last use.

An indicator LED provides valuable feedback for users, and the simple design allows it to be integrated with different spout styles from gooseneck to straight.

FEATURES

- Upgrade to existing infrastructure
- Default 72hr automatic self-flush from last use (can be 24 hrs)
- Resilient chrome plate finish
- Smooth bevelled edges
- Low Power usage
- Active operation indicator LED
- Cost effective solution
- Simple installation



Order Code: 100-0103

TYPICAL DIMENSIONS

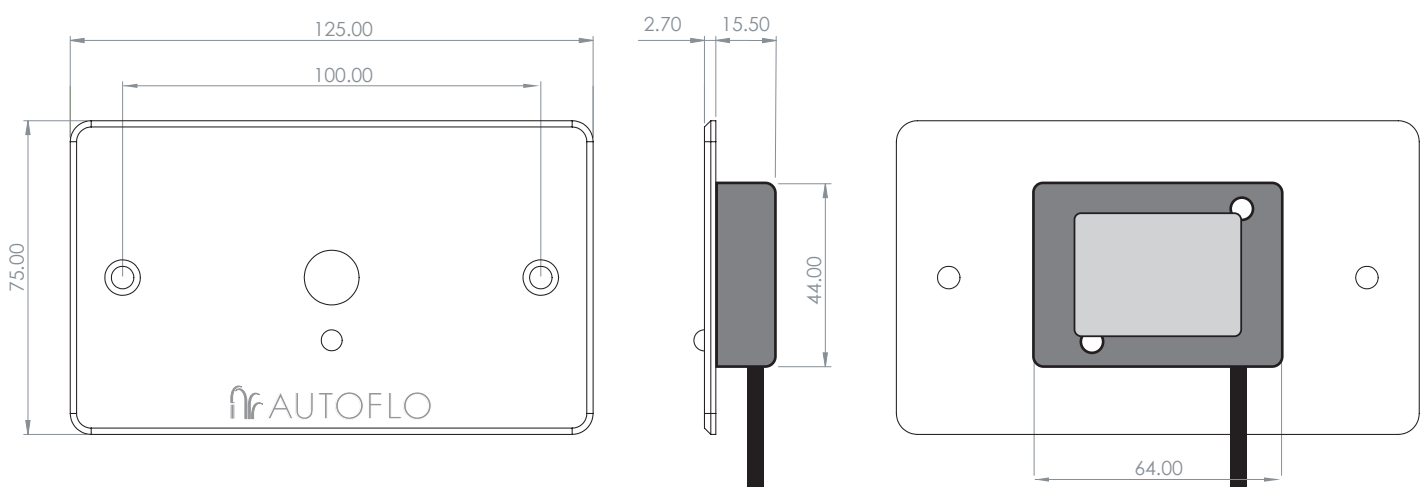

TECHNICAL SPECIFICATIONS

- SENSOR TYPE - Infrared Wave On/Wave Off
- SENSOR RANGE - 60mm factory set
- POWER SUPPLY - 24v AC Power Pack
- OPERATING PRESSURE - Maximum 500kPA
- RUN TIME - Set at 10 mins (can be adjusted)
- FLOW RATING - Dependant os spout
- SOLENOID - 24V
- MAX TEMPERATURE - 50°C

COMPONENTS SUPPLIED

	Item Code	Description
1	100-0101	Wall mount Sensor WO/WO
2	N/A	screws & wall plugs
3	300-0183	24V AC Solenoid Valve
4	300-0124	22V Power Pack
5	300-5088	Connection Cable Loom

TYPICAL INSTALLATION PROCEDURE

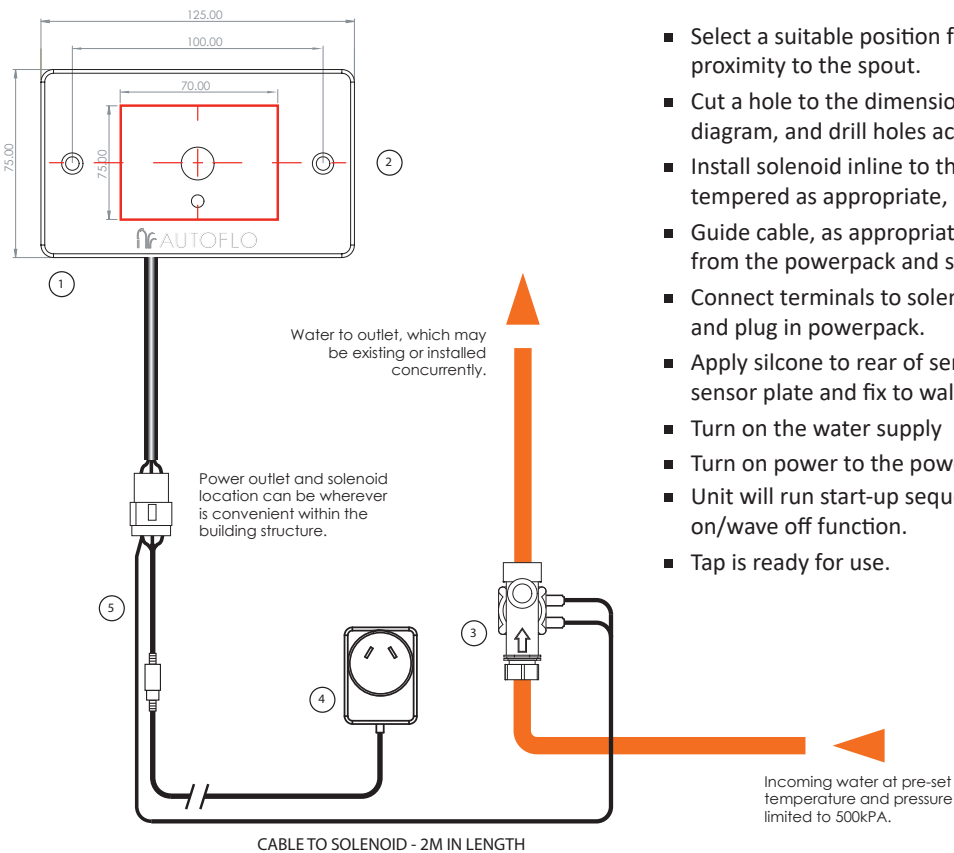

- Select a suitable position for the sensor, in close proximity to the spout.
- Cut a hole to the dimensions outlined in installation diagram, and drill holes accordingly - fit hole plugs.
- Install solenoid inline to the outlet, ensuring water is tempered as appropriate, before solenoid.
- Guide cable, as appropriate to the cut hole in the wall from the powerpack and solenoid positions.
- Connect terminals to solenoid (orientation not critical) and plug in powerpack.
- Apply silicone to rear of sensor plate, connect cable to sensor plate and fix to wall.
- Turn on the water supply
- Turn on power to the powerpack
- Unit will run start-up sequence, test sensor wave on/wave off function.
- Tap is ready for use.

